

**OTC**  
**Community Development District**

**Public Facilities Report**

Dated: February 18, 2018

Governmental Management Services, LLC  
District Manager  
475 West Town Place, Suite 111  
St. Augustine, Florida 32092  
(904) 940-5850

**Table of Contents**

I. Introduction..... 1

II. Description of Existing Public Facilities.....1

1. Stormwater Management System.....1

III. Proposed Additions or Modifications of Public Facilities.....1

IV. Replacement of Existing Public Facilities.....1

**Exhibits**

A. Development Map..... Exhibit A

## **I. Introduction**

The OTC Community Development District (the "District") is a local unit of special-purpose government established pursuant to Chapter 190, Florida Statutes, for the purpose of providing, operating and maintaining infrastructure improvements, facilities and services to the lands within the District. The District covers approximately 98+/- acres of land within Duval County, Florida.

Construction of the Development has been complete since 2008 serving approximately 850,000+/- square feet of commercial retail, restaurants, home improvement and gas stations.. The only public facilities infrastructure that was retained by acquired by the District are the storm water management facilities The infrastructure improvements, as outlined herein, are necessary for the function development of the District and provide a direct and specials benefit to the lands within.

## **II. Description of Existing Facilities**

### **1) Stormwater Management System**

The District acquired the stormwater management system for the entire District boundary. The system is composed of two retention ponds, equalizer pipes, outfall pipe and control structures. The system is fully operational and are owned and operated by the District. At this time and no repairs have been required to date.

## **III. Proposed Additions or Modifications of Public Facilities**

The District currently does not currently have plans to add or modify any public facilities

## **IV. Replacement of Existing Public Facilities**

The District does not currently propose to replace any public facilities.

SR 23 (BRANAN-CHAFFEE ROAD)

<b>SITE LEGEND</b>	
—	PROPOSED STORM SEWER
—	CDD BOUNDARY
—▶	OFF-SITE FLOW ARROW

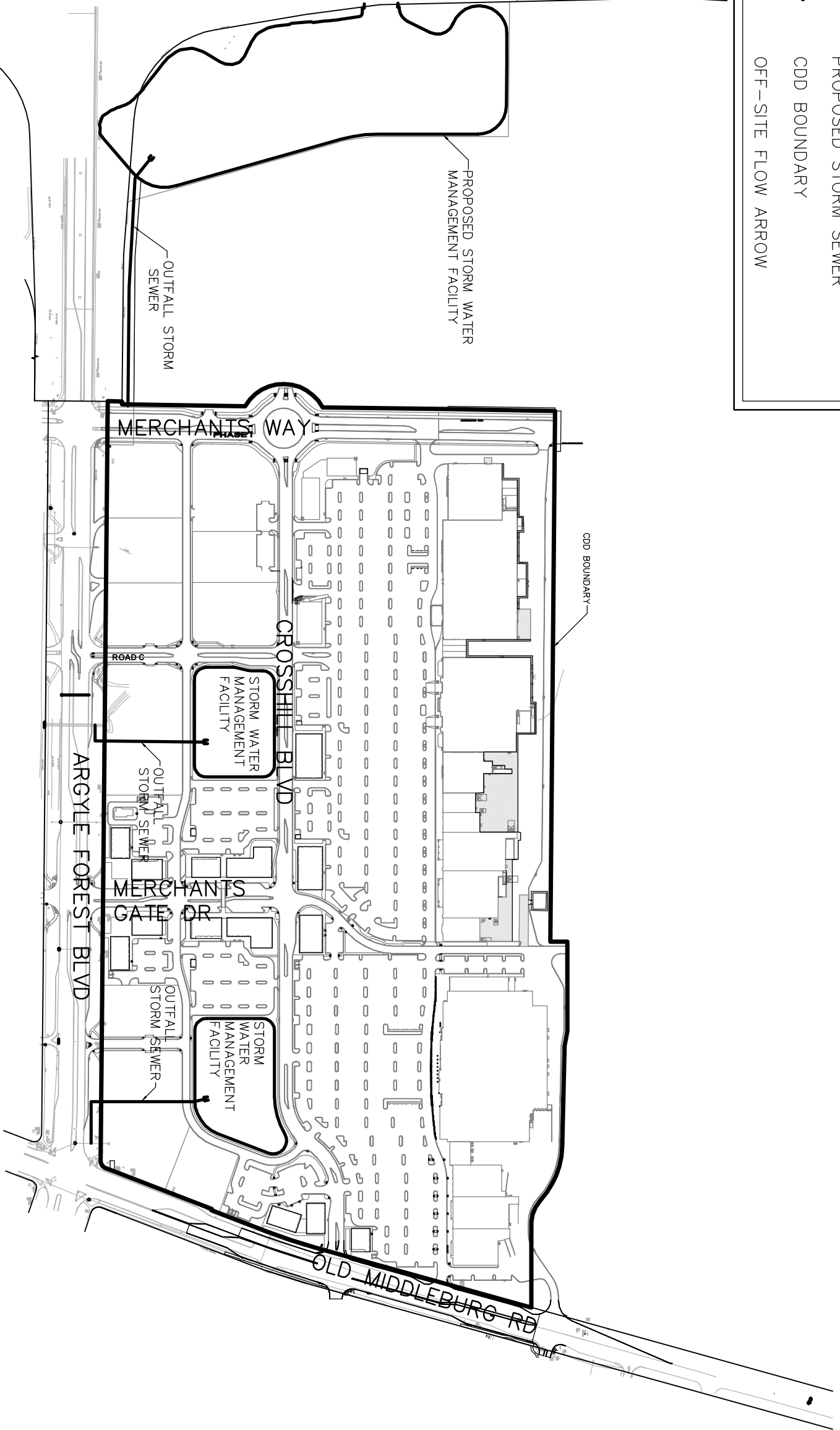

<b>EXHIBIT A</b>	DRAWING NO.	<b>DEVELOPMENT MAP</b>		ETM NO. 05-110	REVISIONS:
		<b>OTC COMMUNITY DEVELOPMENT DISTRICT THE SEMBLER COMPANY JACKSONVILLE, FLORIDA</b>		DRAWN BY: JWC, BTH, BLW	
				DESIGNED BY: KSH, JWC, BTH	
				CHECKED BY: KSH, P. MA	
			DATE: 5/8/06		